

H&G HOUSES

GARDEN The property is not on town water so an underground tank was installed and a bore drilled to ensure water for the 0.8ha of lawn and gardens bordering the cottage. Landscaping by Distinctive Living Design. Verandah chairs, Dickson Avenue. Southport Curve stool, Globe West. **BREAKFAST NOOK** A layered materials palette elevates the sophisticated but restrained colour scheme. Roll & Hill 'Modo' chandelier, Space. Hoffmann chair, Thonet. Banquette upholstered in Verona leather from Contemporary Leathers. Phillip Jeffries 'Diamond Weave' wallpaper. **Local hero:** Embellish dining table, from \$5600, Zuster.



Double happiness

A 1910 cottage in Sydney's southwest presented a pair of land-lovers with the opportunity to create a retreat that delivers on practicality *and* charm.

STORY *Judy Pascoe* | STYLING *Terri Shannon* | PHOTOGRAPHY *Armelle Habib*

inding this home, a circa-1910 cottage on acreage on the outskirts of Sydney, was a stroke of luck for Peter and Carolyn Meadows. Known as Boorabee, it was perfectly located and had significant heritage features. “We were attracted by the home’s potential,” says Carolyn. “We had been looking for a house that was all on one level with some land around it, but still close to town. Boorabee is less than 80km from the Sydney CBD and close to local shops and transport, yet still feels rural.”

Making Boorabee home wasn’t going to be easy. Peter and Carolyn planned to share the property with their adult sons Marcus and Daniel, daughter-in-law Elyse and 20-month-old granddaughter Layla, but at a minuscule 11m², the cottage would be a pretty tight squeeze. All the key elements had to be replaced – roof, verandah, timberwork, doors and windows, wiring and plumbing – and heritage listing required careful navigation of building restrictions. Space to entertain was also high on the wish list.

After consulting a local architect and town planner, Carolyn and Peter came up with a plan for a two-bedroom extension linked to the restored cottage via a breezeway. “The new structure couldn’t be higher or more imposing than the original,” says Carolyn. “The solution was to tuck the extension ▶



THIS IS THE LIFE

Accommodating the needs of three generations can be a challenge, but Boorabee manages it with aplomb. Carolyn says she is hard pressed to nominate a favourite space. “The family room is amazing. It comfortably seats 10, which is fantastic when we all come together on a Sunday night. And we all love having movie nights in the home cinema. It feels relaxed and cosy but still a bit special – like going to Gold Class.”



‘I LOVE ALL THE NATURAL MATERIALS, ESPECIALLY THE STONE AND TIMBER. IT FEELS REALLY HOMELY.’ Carolyn

KITCHEN Above left and opposite Abundant natural light was a must, says owner Carolyn Meadows. Silver Corona stone benchtops, Apex Stone. Inax ‘Yohen Border’ tiles (splashback), Artedomus. Wolf freestanding oven, available from Winning Appliances. Lismore rangehood, Qasair. Yokato mixer tap, Brodware. Stools, Thonet. Roll & Hill ‘Modo’ sconce, Space. Flooring, Royal Oak Floors (throughout). **FAMILY ROOM** Chic and super comfortable yet easy-care thanks to slipcovers and wipe-clean surfaces. Rialto armchairs, Wills Furniture. April side table, Zuster. Diamond ottoman, Arthur G. Fireplace, Cheminees Philippe. Aren Gris tiles (fire surround), Stonetile Ind. **Smart buy:** Tangier rug in Limestone, from \$1270, Armadillo&Co. **BREAKFAST NOOK** Carolyn says the family couldn’t be happier with what they have achieved.

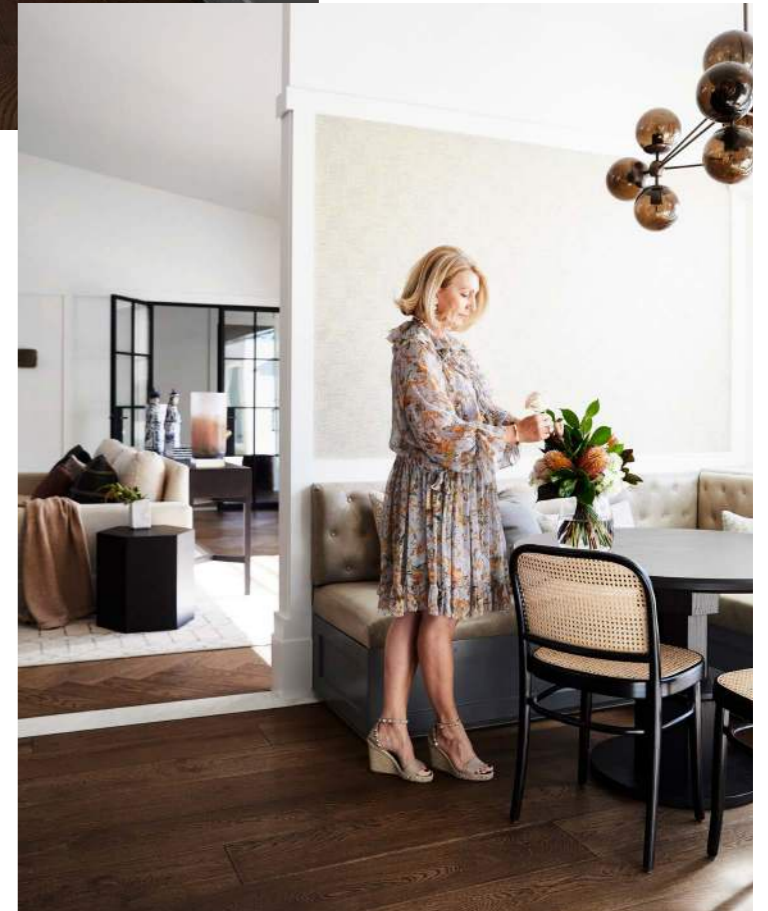

FAMILY ROOM “I just love the steel-framed doors,” says Carolyn. “They are finished in antique brass, which is used throughout the house.” Rialto armchairs, Wills Furniture. April side table and Tribute console, both Zuster. Tangier rug, Armadillo&Co. Curtains in JAB Anstoetz ‘Dorset’ fabric, available from Seneca Textiles. Artwork by Colin Pennock. Accessories, all Bloom & Co. **Local hero:** Leila three-seater sofa, \$5740, Jardan.

behind the cottage, separating the rooflines so it looks like a cluster of smaller buildings.” A central entertaining courtyard and pool area neatly connects old and new.

The home’s main entrance, now relocated to the extension, opens to a spacious foyer and, across the hall, a generous open-plan kitchen/family room. Immediately to the left of the entrance is the home cinema; down the hall is the original cottage, now accommodation for Daniel, Elyse and little Layla. Following the corridor to the right leads to the study, Marcus’ bedroom, dining room and Carolyn and Peter’s sumptuous main bedroom suite.

Construction complete, the couple engaged interior designer Terri Shannon, director of Bloom Interior Design & Decoration to create a decorating scheme that would unite the two halves of this whole. “We settled on a classic-contemporary aesthetic, with a luxurious, distinctly Australian feel,” says Terri. In the cottage, period or replica fittings

were used wherever possible to maintain the character; in the extension, they opted for modern takes on those elements. A colour palette of greys and creams, used indoors and out, is the unifying thread.

As well as more than tripling the living space, Peter and Carolyn took full advantage of the opportunity to bring Boorabee into the 21st century, installing a state-of-the-art sound system, solar panels and a bore-water system for the gardens. “It’s so comfortable to live in and easy to look after,” says Carolyn.

Boorabee is very much a working property, with the couple keeping sheep, polo horses and chickens on their 10.9ha holding. But thanks to all the luxe touches, the home feels more like a country retreat, says Carolyn. “We never take the beauty around us for granted. We just love being home.”

Bloom Interior Design & Decoration, Williamstown, Victoria; (03) 9397 4343 or bloominteriordesign.com.au.





MAIN BEDROOM *Above left* The sumptuous main bedroom feels more like a luxe hotel. Evans sconce, Laura Kincaid. Artwork by Min-Woo Bang. Domain Textiles 'Hanmadang 3509' wallpaper, Grant Dorman Interior Products. **MAIN ENSUITE** Touches of brass add warmth in the cool-neutral scheme. November wall/floor tiles, Classic Ceramics. Seascapes bath, Apaiser. Basins, Rogerseller. Yokato tapware and towel rail, Brodware. Circa Lighting 'Graydon Double Bath' wall lights, Cromwell. **DRESSING ROOM** There really is a place for everything in this thoughtfully designed space. The joinery echoes that in the kitchen. Ottoman upholstered in Unique Fabrics 'Bello' velvet. Natural Velvet carpet in Pinto, Prestige Carpets. **ANTEROOM** *Opposite* The anteroom helps the couple shrug off the day before entering the sanctuary of their bedroom. Celeste side table, Arteriors. Sommerard floor lamp, Bloomingdales Lighting. Benson wingback chair, Arthur G. **Smart buy:** Ambient Fade artwork, \$1710, Boyd Blue.



Feature Plants

- Rosmarinus officinalis*
‘Tuscan Blue’
- Cotton lavender
(*Santolina chamaecyparissus*)
- Dwarf wormwood
(*Artemisia ‘Powys Castle’*)



The Layout

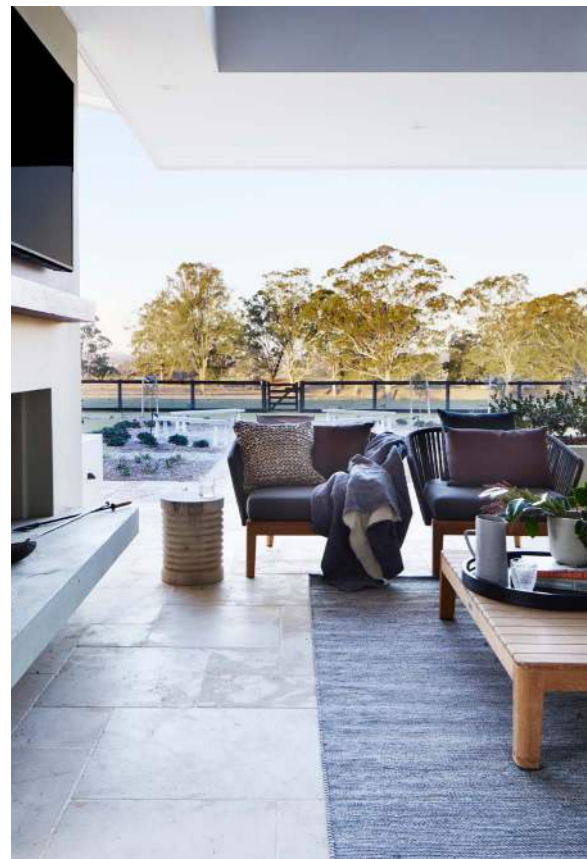
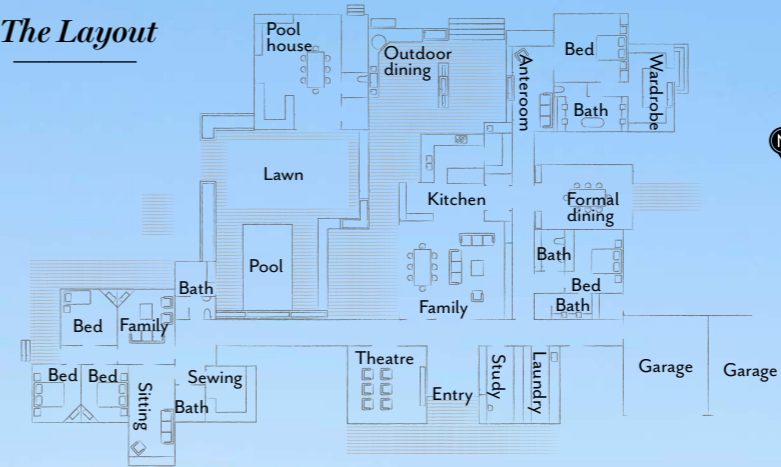

The Palette

Dulux Natural White (main interior walls)

Porter's Paints White Rhino (kitchen/dressing room joinery)

Dulux Dark Bronze (feature doors)

‘THE COTTAGE TOOK A LOT LONGER TO RESTORE THAN ANTICIPATED BUT IT’S JUST BEAUTIFUL.’ *Carolyn*

FRONT GARDEN The gardens were “neglected and overgrown” when Carolyn and Peter bought the property. Today, the grounds have been beautifully landscaped by Distinctive Living Design. **OUTDOOR LIVING** This alfresco space allows the family to feel at one with their surroundings without forgoing creature comforts. Fireplace, Cheminees Philippe. Tribú outdoor setting, Cosh Living. Rug, Armadillo&Co. Beauford sandstone pavers, Eco Outdoor. **FIRE PIT** Everyone – including the horses – enjoys the serenity at Boorabee. *For Where to Buy, see page 190. H&G*