



Accustomed TO STYLE

Global styles converge in a Spanish Mission house in Melbourne, refreshed by a family who wish to embrace formality and fun in equal measure.

STORY JUDY OSTERGAARD / STYLING TERRI SHANNON / PHOTOGRAPHY ARMELLE HABIB



This is the life

Owners Colleen and Paul Cross love entertaining. "We have the formal dining and sitting rooms at the front of the house, or we can open the french doors in our living area and invite the outside in," says Colleen. "The pool is solar- and gas-heated, which extends its use. It's very handy as we live close to our boys' school and there are always children over for a visit."

POOL / Maclane with cavoodles Bella (left) and Charlie. The Akira Takizawa-designed teahouse is decked out with cushions from Bloom Interior Design & Decoration.
FORMAL DINING / Generously cut silk curtains, custom-made by Bloom Interior Design & Decoration, add a sumptuous note to this room. Lenoir dining chairs, La Maison. The rug was custom-made by Halcyon Lake. Peacock artwork, Decorator's Art. Designer buy: Ancien mirror, \$699, La Maison. FOR WHERE TO BUY, SEE PAGE 222.

One of several Spanish Mission-style houses built on the heritage-listed Reid Estate in Melbourne's inner east, this 1930s home boasts a restored stucco exterior and the beautiful arched verandah surrounds typical of that architectural style.

Colleen and Paul Cross bought the property in 2011 and moved in with their four children, Taylah, now 19, Joshua, 16, Maclane, 11, and Jenna, 10, and a gaggle of pets. With an earlier extension by architect Nicholas Gioia, which encompassed an open-plan living area, three bedrooms and bathroom, the house was already liveable.

They resisted changing anything for a couple of years before enlisting Terri Shannon of Bloom Interior Design & Decoration to help put their stamp on the property. "My brief to Terri was French Provincial meets the Hamptons in New York state style – all in a Spanish Mission house. So it was quite a challenge," says Colleen. "The main criterion, aside from the style, was that it had to be functional for four children and five pets; we wanted a home where everyone would feel welcome as well as comfortable."

"The house was missing that homely feel," says Terri. "It needed new furniture and accessories in almost every room. Colleen and Paul knew what they liked but just needed help putting it all together." Terri began by repainting the interior walls and restaining the



DINING / The sideboard is placed to divide the living and dining areas in the open-plan extension. Grange Ateliers de Grange dining table and Sika-Design Rossini dining chairs, Domo. Custom-made rug, Halcyon Lake.
KITCHEN / "The kitchen didn't need much work, but we added the industrial antique-silver pendants and the clock to reflect the chrome hardware in the joinery," says Terri. Clock, Meizai.
Smart buy: Madison hanging lamp, \$1025, Emac & Lawton. FOR WHERE TO BUY, SEE PAGE 222.

Inspired decorating

"I like Hamptons style – it's casual, relaxed and calm – and that's how I wanted the house to feel," says Colleen. "But I also love the tradition and character that is part of the French Provincial style, particularly the detailed furniture. I think we have achieved a blend of the two genres: a comfortable house but one with lots of interest, character and style. We are so proud of our home; it suits us and our family."

"The living and dining area have a more casual feel. It's a light and airy space so we kept the walls fresh and white." Terri

MAIN BEDROOM / Silvery greys and blues are restful choices. Rupert rug, The Rug Collection. Custom-made velvet bedhead and cushions, Bloom Interior Design & Decoration. Lamps, Bloomingdales Lighting & Decorator Accessories. Prints, Cromwell (Australia).
SITTING ROOM / Terri selected a cream, white, soft blue and grey palette for the formal front-of-house rooms. The timber floors were also stained a darker walnut colour to "achieve a greater level of grandness" throughout the house. Dimple ottoman, Molmic. Cato sofa, Furniture Inspirations. Designer buy: Flemish chandelier, \$2160, Laura Kincade.
LIVING / The stacked-sandstone chimneybreast is a beautiful focal point while well-considered joinery makes the display of family treasures a pleasure. Armchair reupholstered in a Westbury Textiles fabric. Tripod table, Cromwell (Australia). Drift rug, Armadillo&Co. **FOR WHERE TO BUY, SEE PAGE 222.**



See more of this beautiful house by scanning this page with the **viewa** app.

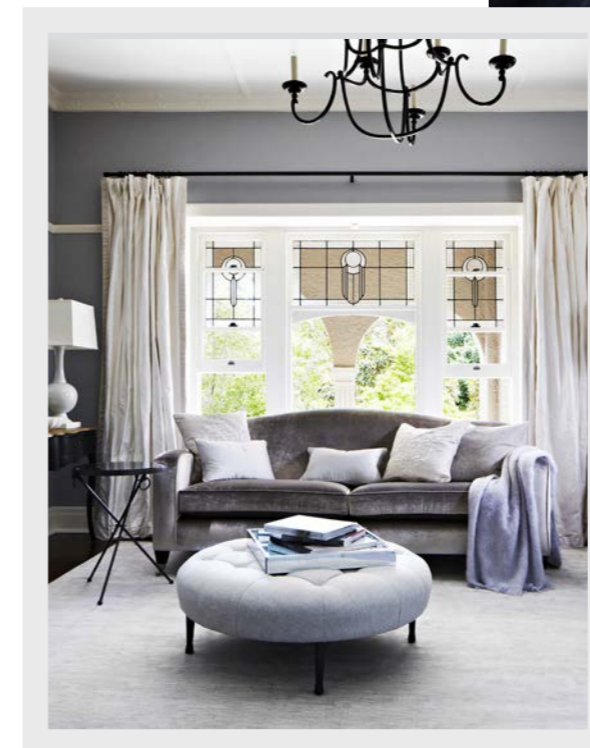

THE LAYOUT

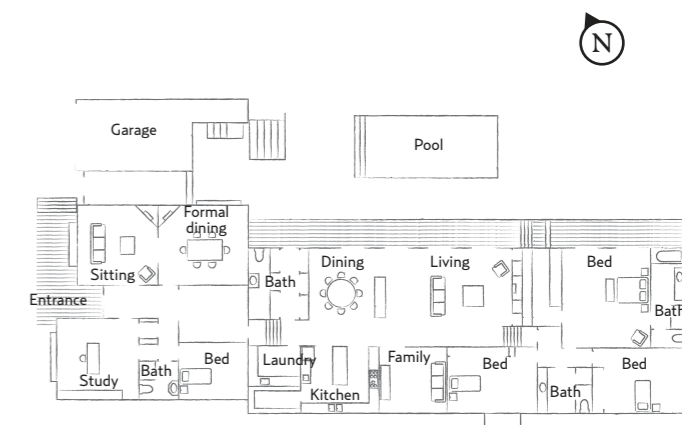

THE PALETTE

Porter's Paints
Dusty Mule
formal living,
dining

Dulux
Natural White
interiors,
throughout

Add a dash of

Resene Azure



◀ floorboards. Window treatments were updated and shutters added to some windows and doors. The original front rooms; the formal dining and sitting room, two bedrooms and a study were refurbished. “All the furniture is new except for our bed, Jenna’s bed, a chair in the living area we had reupholstered and the sideboard that divides the dining and living area,” says Colleen. “It’s a piece Paul and I have had since we bought our first home more than 20 years ago.”

The bulk of the refurbishment focused on the entrance hall. Originally the hall led into a room that was a thoroughfare. Terri pulled these two spaces together by installing timber panelling with wallpaper inserts in both spaces to make them feel like one. “Now, the entrance is one of the areas I love the most,” says Colleen.

A few steps down is the extension with its large kitchen, dining and living area. Four sets of french doors open to the garden and pool. Past the main living area are two more bedrooms and a bathroom. At the rear of the house is the main bedroom and ensuite.

Outside, near the pool, an existing outdoor kitchen was updated to include a gas heater, pizza oven, fridge and an outdoor television that swivels so it can be viewed from the pool. Now that’s living. **H&G Bloom Interior Design & Decoration, Williamstown, Victoria; (03) 9397 4343 or bloominteriordesign.com.au.**

FEATURE PLANTS

- POOL
- Portuguese laurel
- Ginkgo biloba*
- Japanese maple
- SIDE GARDEN
- Crepe myrtle
- (*Lagerstroemia*)
- Liriope muscari*

JENNA'S ROOM / Jenna creates a new drawing to add to the pair beside her bed. Custom-made Meadow rug, Armadillo&Co. Bedlinen, Adairs. Throw, St Albans. **Smart buy:** Enchanted Tree wall sticker, \$275, The Wall Sticker Company.

OUTDOOR / Colleen, Bella and Charlie stroll down the home’s landscaped side path. There are several water features that can be seen from indoors.

BATHROOM / The family was fortunate to inherit a beautiful bathroom. Their only addition was shutters from Think Shutters. **FOR WHERE TO BUY, SEE PAGE 222.**

Paint colours are reproduced as accurately as printing processes allow.

